

## TROUBLESHOOTING GUIDE FOR THE SHOWER TRAY WASTE UNIT

SOLID FLOOR  
INSTALLATION

✓OK

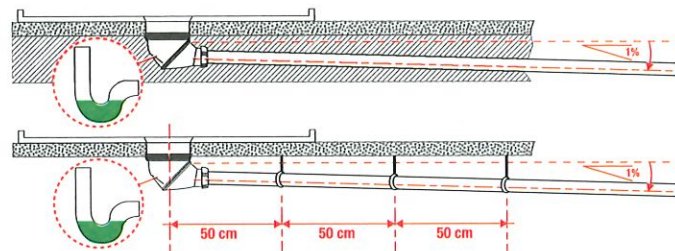

CAVITY FLOOR  
INSTALLATION

✓OK

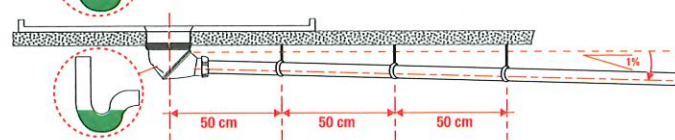

ENSURE THAT THE WASTE INLET IS PROTECTED WHEN FITTING OR RENOVATING THE SHOWER TRAY, SO AS TO AVOID ANY DEBRIS FALLING INTO THE WASTE TRAP BODY.

### PROBLEMS

### CAUSES

### SOLUTIONS

Reduced or even  
zero flow rate

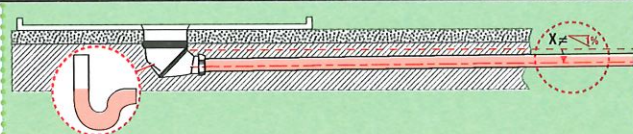

Re-install - Use the  
correct installations.  
Check there is the required  
minimum 1% slope

Do not use  
90 degree bends.  
Always use curved bends

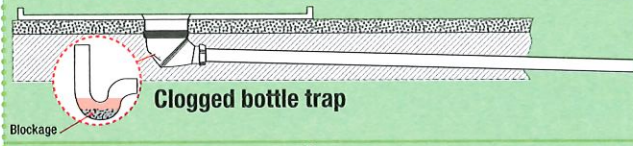

Any sharp bends  
or series of bends/joints  
will adversely affect  
the water flow rate

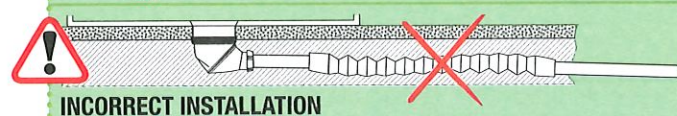
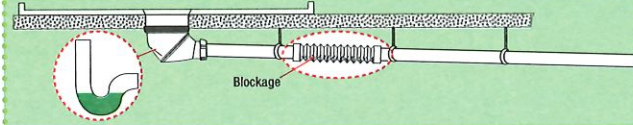

INCORRECT INSTALLATION

Do not use flexible pipe on the  
outlet as this interferes with the  
suction created by the Twisto waste unit

Water flows back  
into the shower tray  
Trap flow rate problems

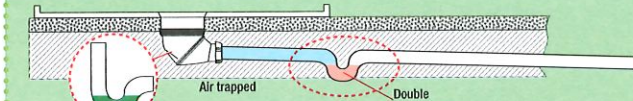

Re-install - Use the  
correct installations (i).  
Remove the second bottle trap

Tube vibration,  
water leaking  
from the seal

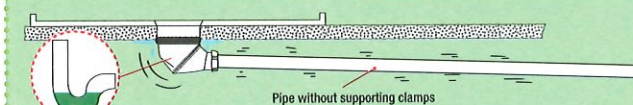

Fit pipe supporting clamps.  
Use the correct  
installations as above (i).

## CLEANING AND MAINTENANCE GUIDE - SHOWER TRAY AND WASTE UNIT

### SHOWER TRAY

**CLEANING:** Clean regularly with a damp cloth or sponge and buff with a soft dry cloth. Occasionally use a **NON ABRASIVE** cleaner to remove stubborn stains and buff with car polish to give a perfect finish. Do not use stiff brushes, scourers or abrasive cleaners. These can damage the surface of the tray.

**LIMESCALE:** In hard water areas, limescale will mark the surface of the tray. To prevent this use a good quality water softener. Limescale can be removed with an application of automotive T-Cut followed by car polish (always use a soft dry cloth). Please note: constant repetition of this process is not recommended as it will gradually remove the gel coat surface.

**HAIR DYES:** Some hair dyes contain abrasive chemicals which can damage or mark the surface of the tray. It is essential to rinse all residue dye from the surface of the tray **IMMEDIATELY** after use to prevent damage.

**LIGHT SCRATCHES/MARKS:** Although the gel coat surface of your tray is extremely hard, it can be marked during showering by sand or other abrasive substances. To remove, apply automotive polish and buff with a soft cloth. More prominent marks or scratches (that have not exposed the resin below the gel coat surface) can be removed by first applying automotive T-Cut.

**DEEP SCRATCHES/CHIPS:** Sometimes heavy items can be accidentally dropped onto the tray surface exposing the resin beneath. This can be clearly identified as it is dark brown/grey in colour. To repair, firstly examine the area around the impact. If no cracks are detected, ask your retailer/installer for details of the TM25 shower tray repair kit. This consists of everything necessary to complete a satisfactory repair.

**RUBBER MATS:** These may cause marking on the surface of the tray as they sometimes react with soaps, shampoos, dyes etc. Although not recommended, they may be used providing they are always removed from the tray after showering and the tray surface rinsed down to wash away any residues/fragments of rubber. **DO NOT OBSTRUCT WASTE COVER WITH MAT.**

### WASTE UNIT

To access waste unit, simply remove the stainless steel waste cover. The waste unit has been specifically designed to be self cleaning so small and medium sizes items will pass through automatically as part of the normal function of the waste.

Larger items such as hair clips etc., may be too large to pass through the waste and will remain in the top of the unit for easy removal. These items may impede water flow and can lead to a build up of water in the showering area so it is important to regularly check and remove any debris in the waste unit.

# 25mm SHOWER TRAY FITTING INFORMATION

**IMPORTANT INFORMATION - PLEASE READ PRIOR TO UNPACKING AND INSTALLING YOUR SHOWER TRAY. INCORRECT INSTALLATION WILL INVALIDATE YOUR GUARANTEE. IT IS RECOMMENDED THAT THE PLUMBING AND INSTALLATION ARE CARRIED OUT BY QUALIFIED PERSONNEL AND IN COMPLIANCE WITH REGULATIONS.**

Figure 1

### IMPORTANT INFORMATION

#### PLUMBING OUTLET - LEFT AND RIGHT ONLY

The waste outlet can be plumbed either to the left or to the right edge of the shower tray.

Plumbing Left drains up to 30 litres per minutes and, Right up to 20 litres per minutes.

For plumbing guide for the waste outlet see Figures 2, 3 and 4.

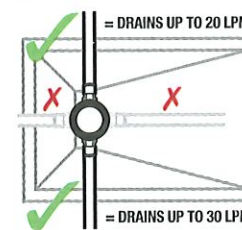

Figure 2

Outlet Pipe  
25cm (min)  
There must be 25cm of straight outlet pipe before any bends are added.

Figure 3

Outlet Pipe  
45°  
Only a 45 degree angle joint can be connected directly to the waste unit.

Figure 4

Outlet Pipe  
90°  
DO NOT connect any 90 degree joints directly to the waste unit as water flow will be restricted.

**IMPORTANT INFORMATION: ONLY USE CURVED BENDS**

### PRIOR TO FITTING

- Check the product thoroughly prior to fitting. Unfortunately, no claims for imperfections can be made once the tray has been installed.
- The tray must be fitted in **STRICT** accordance with the installation instructions. Failure to fit and maintain the product as per the instructions will invalidate the guarantee and possibly lead to long term damage.
- The use of any materials other than those specified in the fitting instructions could result in the shower tray failing, and will invalidate the guarantee. Alternative products used as bedding material (eg. Silicone, tile or general adhesive) are not suitable as they allow movement underneath the tray. This can cause the tray to 'flex' which can result in a stress fracture.
- ONLY** fit the waste unit supplied with the tray (Wirquin Twisto). Fitting any other waste unit may lead to a reduction in water flow.
- This shower tray and waste unit combine to achieve European EN274 approval for water drainage. Together, they are designed to provide a water flow rate of over 30 litres per minute. High water pressure and 'deluge' shower heads can result in water flow rates exceeding the waste unit capacity (a restrictor valve may be required). Failure to fit the waste unit provided in accordance with the fitting instructions may reduce water flow and create drainage problems.

There should be no movement or flexing in any wooden flooring or support under the tray. Flooring should be secured to joists, and noggins should be added between joists under the waste hole area of the tray. Any movement beneath the tray may result in a stress fracture and invalidate the guarantee.

**NB.** Whilst all trays are inspected during the manufacturing process, in rare cases due to the centre weight load of the stone resin, transport and storage can cause the tray to move slightly out of tolerance. If you have measured your tray and it appears out of tolerance, simply support the tray under each corner for a few hours and the tray will revert back to factory tolerances.

LIFETIME GUARANTEE - REGISTRATION FORM

To ensure that your shower tray guarantee is valid, the tray must be fitted in accordance with the manufacturers instructions enclosed. For further information, please contact your retailer.

Name: \_\_\_\_\_

Address: \_\_\_\_\_

Postcode: \_\_\_\_\_

Email: \_\_\_\_\_

Telephone: \_\_\_\_\_ Retailer/Tray Size: \_\_\_\_\_

☐ I confirm that my shower tray has been fitted in accordance with the instructions and understand that failure to do so will invalidate my guarantee.

Signature: \_\_\_\_\_ Purchase Date: \_\_\_\_/\_\_\_\_/\_\_\_\_

Please sign & return this guarantee within one month of purchase to: Customer Care - Traymate Products Limited - Firm Mills, Grove St, Longwood, Huddersfield HD3 4TH.

### HOW TO CHECK THE TOLERANCE



### WHAT TO DO IF THE SHOWER TRAY HAS MORE THAN 5mm TOLERANCE

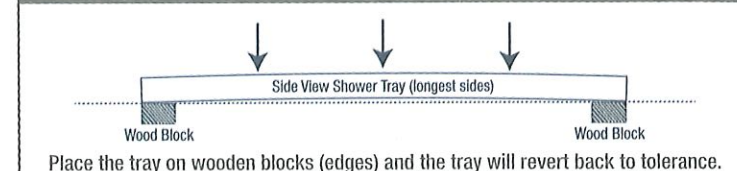

### DURING FITTING

Connect the waste unit to standard straight outlet pipe. **DO NOT** use flexi-pipe as this interferes with the suction created by the waste unit and reduces water drainage. Always use curved joints for any bends in the outlet pipe.

- The outlet pipe should have a minimum of 2% fall. Ensure the outlet pipe does not vibrate or wobble.
- The waste unit inlet should be covered to protect from debris falling into the waste body. Once connected, check there are no blockages.
- DO NOT** over-tighten the flange screws when attaching the waste unit to the tray, as this can cause the tray to crack
- The tray should be water tested before the final fix.
- Cover and protect the tray when tiling and fitting shower tray and enclosures.

### DOORS/SCREENS AND SHOWER HEADS

Always fit a door or screen unless fitting as part of a wet room. Never fit a shower head at the open end of an enclosure.

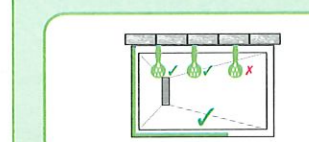
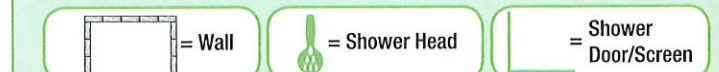

Walk In - Front & Side Panel

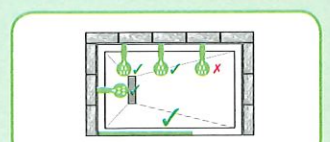

Walk In - Front Panel



Door Enclosure

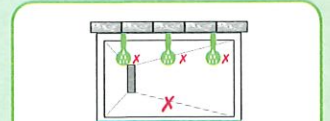

Walk In - Center Panel



Square - Full Enclosure Only

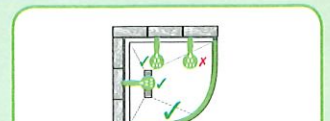

Quadrant - Full Enclosure Only



No Panel/Enclosure



Two End Panels



## PLUMBING GUIDE

If you do not want to cut out this template, you can download and print a copy online at: [www.tmuk.net](http://www.tmuk.net)

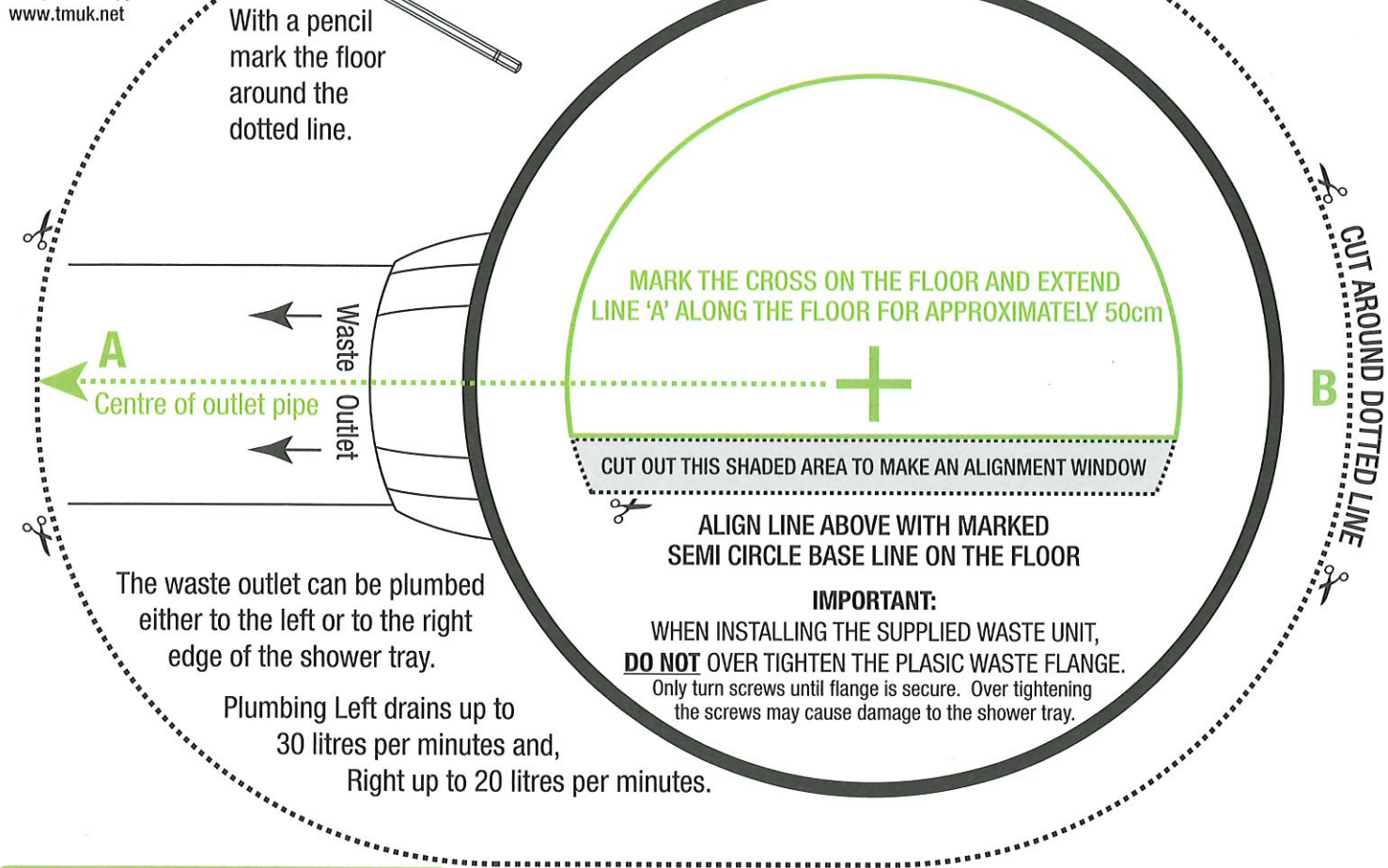

## TEMPLATE AND WASTE GUIDE

Please read the important information below first, and follow the full 'Fitting Instructions'. Use the template guide ONLY to cut out the waste area. This will ensure minimum stress to the shower tray. Failing to do so, may weaken the shower tray and cracking may occur.

1. Place the shower tray in the required position on the floor.
2. Draw a line around the entire waste outlet with a pencil.
3. Move the tray to a safe location to prevent accidental damage.
4. Cut out the template.
5. Overlay the semi circle template on the drawn semi circle on the floor. Align into correct position.
6. Mark the centre cross point on the floor. This will represent the centre point of the waste unit.
7. With a pen or pencil, Extend line A (marked on template) onto floor for approximately 50cm. This will provide a guide for the centre point of the waste outlet pipe.
8. With a pen or pencil draw around the outer edge of the template B.
9. Remove the template and cut out the floor board. Ensure that the hole is not cut oversized.
10. Lift flooring and fit plumbing to the waste trap position.

NOTE: there is a safe error margin of 15 degrees when plumbing to the waste outlet.

## WOOD FLOOR

It is essential that all flooring is properly secured, ensuring there is no movement or flex. Any joins in the flooring that are not supported by a joist must be supported by a separate noggin. Any flooring that flexes between joists MUST also be supported by additional noggins.

Ensure that flooring around the waste hole is fully supported by noggins. There must be no floor movement around the cut hole.

See fitting instructions for detailed illustrations and information.

## WASTE UNIT INSTRUCTIONS - TWISTO Ø90

- Only use the waste unit provided. Fitting an alternative waste unit will compromise water flow.
- It is strongly recommended that a qualified plumber completes the waste unit installation and final plumbing
- To join the outlet pipe to waste unit, use solvent weld. Test for leakage by pouring approximately 2 litres of water into waste unit prior to the final fix.
- Locate plastic flange onto waste unit with the securing screws supplied – Do not over-tighten the screws, only turn until the flange is secure. Over-tightening the screws may cause damage to the shower tray.
- It is essential that the fall angle of the waste pipe is maximised. Fall must be a MINIMUM of 2% to ensure adequate water flow.
- For trouble shooting and Q&A's, please visit [www.wirquin.com](http://www.wirquin.com)

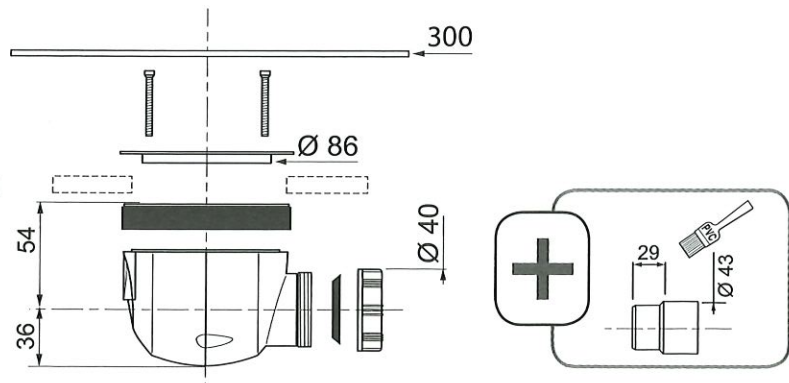

## IMPORTANT INFORMATION

Figure 1  
PLUMBING OUTLET - LEFT AND RIGHT ONLY

The waste outlet can be plumbed either to the left or to the right edge of the shower tray.

Plumbing Left drains up to 30 litres per minutes and, Right up to 20 litres per minutes.

For plumbing guide for the waste outlet see Figures 2, 3 and 4.

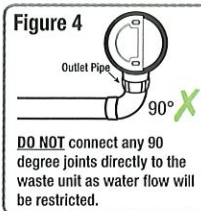
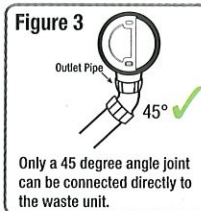
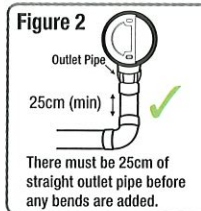

IMPORTANT INFORMATION: ONLY USE CURVED BENDS

## FITTING INSTRUCTIONS - WOOD FLOOR

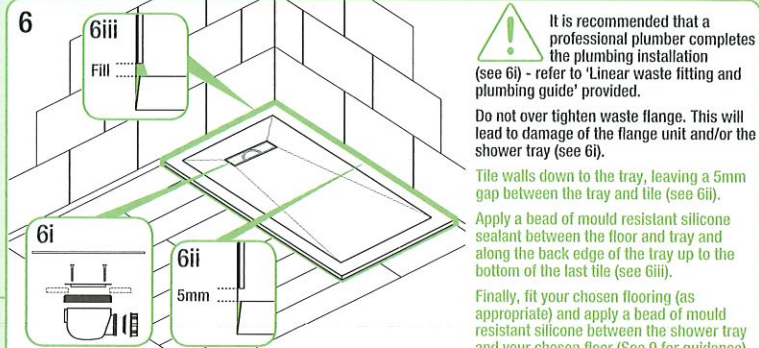
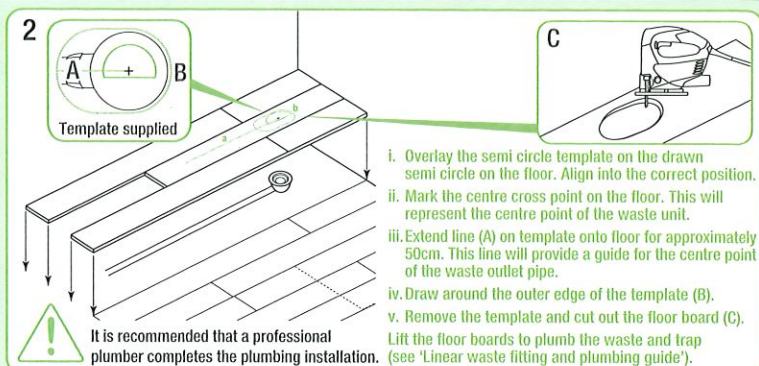
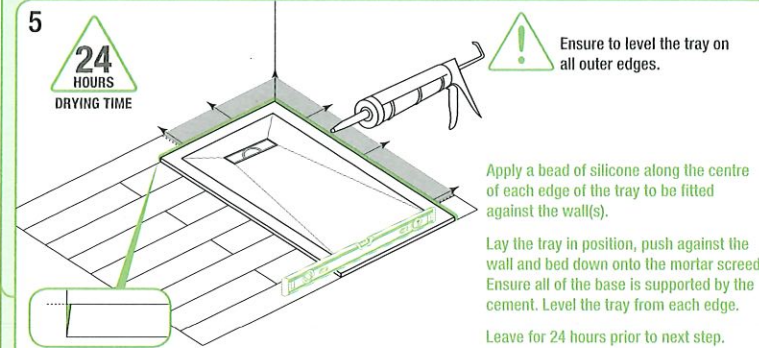
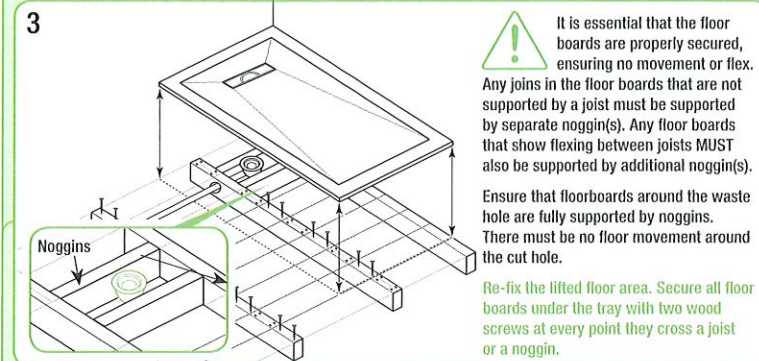
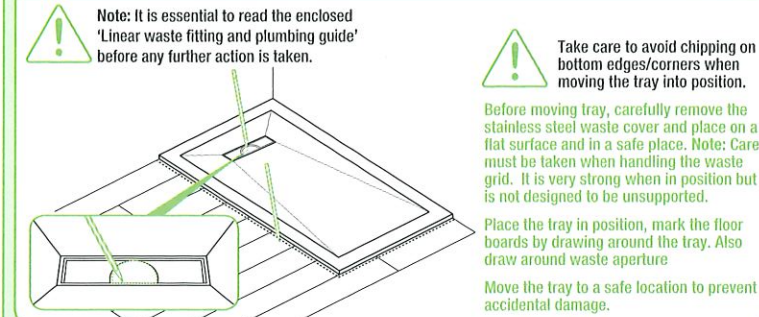

## FITTING INSTRUCTIONS - CONCRETE FLOOR

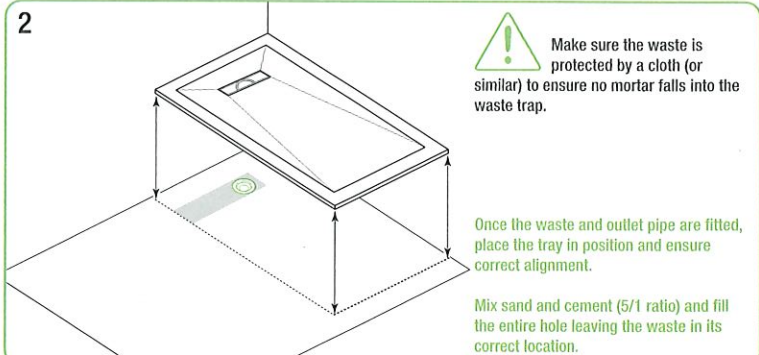
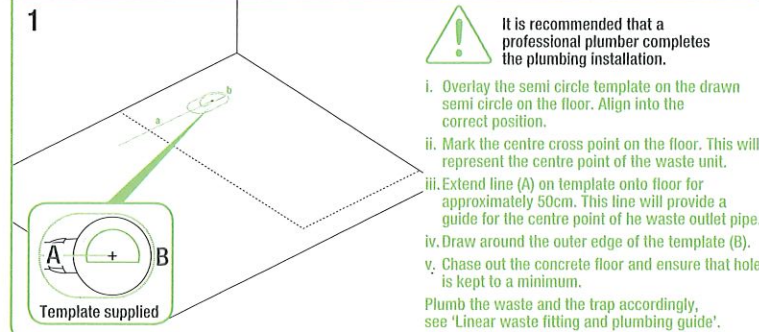

## 3 CONTINUE AS FROM STEP 4 ABOVE TO COMPLETE THE TRAY INSTALLATION.

## FLUSH FITTING - OPTIONAL

Follow stages 1-6 accordingly (as above), taking into consideration the depth of marine ply, tiles and adhesives.

